

## DRAWER LOCK

WM-2000CT-01

### System Description

Vanma® backs up the innovative products we sell with strong utility patents and comprehensive key control agreements, adding the next layer to our customers' security. Expandable Vanma® locking systems can be designed to cover large and extensive facilities and ideally each key holder will carry just one key. For your access management needs we offer solutions that simplify and streamline the administration of keys and user rights. This adds more security and control, improves operational efficiency and reduces operational costs.

### Feature

- Programmable electromechanic lock for Vanma® locking system
- No batteries or external energy source required for the lock
- All Vanma® locks and Vanma® keys are mechanically identical
- Powerful and secure AES256 encryption for common lock and key authentication
- Programmable lock opens with Vanma® keys
- Log memory for openings and opening attempts
- Blacklist for individual lost keys
- Access group list for key accesses
- Updatable firmware



## Drawings

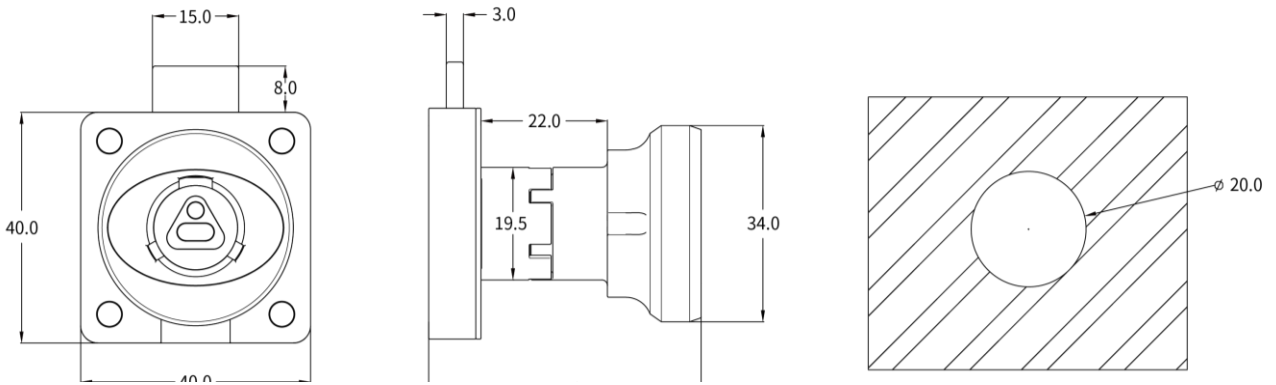

Cut-out

## Memory Capacity

- Blacklisted Keys..... 100 Pcs
- Lock Events.....60 Pcs

## Technical Data

- Physical..... Hardened-Alloy with brushed finishing
- Weight.....177.4g
- IP Standard.....IP68
- Compatible Keys.....All Vanma keys